



AquaBalance[®]

SERIES 2

by  **WEIL-McLAIN[®]**

HEAT ONLY AND COMBINATION GAS WALL MOUNT BOILERS

 **95%**
AFUE energy
efficiency

 **4.0**
GPM*
at 70° rise
minimum

 **80-155K**
heating input

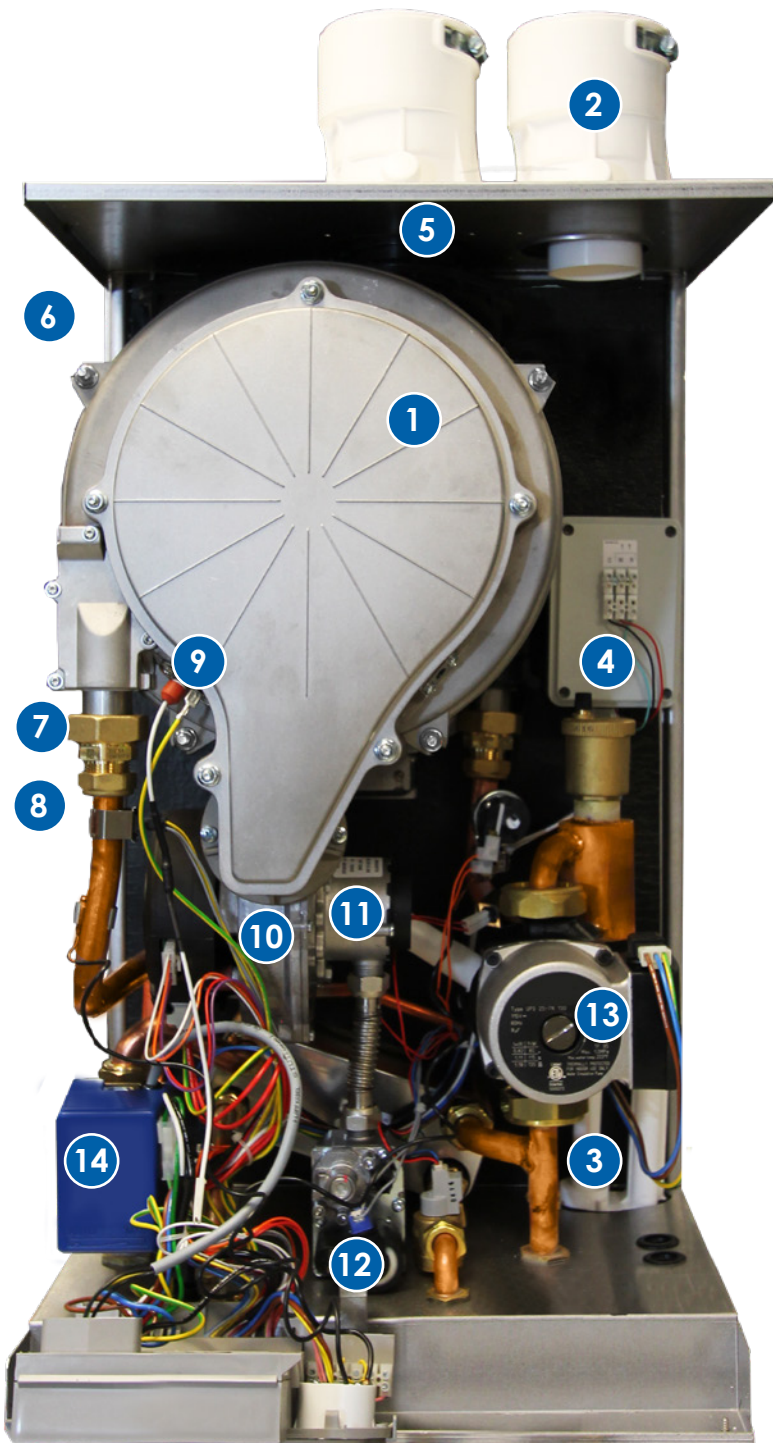

Features include:

1. 1" Diameter ASME certified 316L Stainless Steel single tube heat exchange — low pressure drop
2. 3-in-1 vent adapter — accepts PVC, CPVC, SS or PP materials
3. Internal condensate trap
4. 24 VAC thermostat relay, fuse protected with prewired terminal strip
5. Heavy gauge insulated jacket — provides quiet operation
6. Contractor friendly removable sides
7. Quality brass nuts on heat exchanger for both DHW and space heating
8. Sensors used in place of additional boiler controls
9. Ignitor
10. Blower
11. Venturi
12. Gas valve with 10:1 turn down ratio

Combi Version ONLY

13. Internal 3-speed circulator
14. 3-way valve with bypass lever

Not pictured:

- Digital Display Honeywell Control
- 120V, 6 ft. power cord with plug

*Achieved with 155 BTU combi boiler

DIMENSIONS

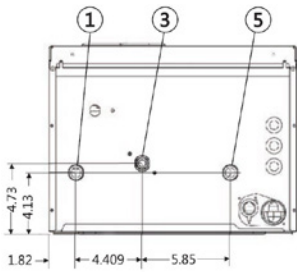

Heating Only Bottom (80/120)

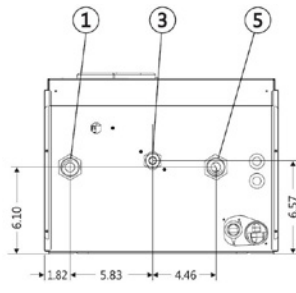

Heating Only Bottom (155)

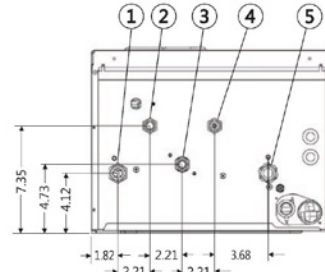

Combi Bottom (80/120)

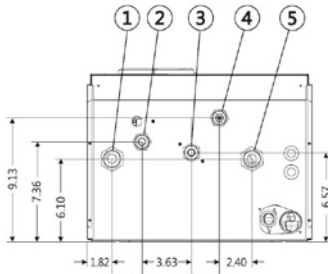

Combi Bottom (155)

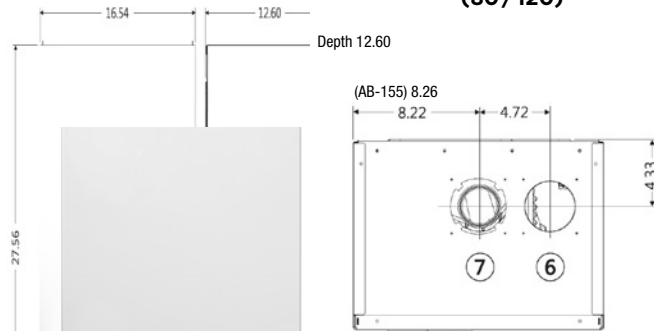

Front (80/120/155)

Top (80/120/155)

Connections (NPT/Inches)

		80/120	155
1	Heating system supply tapping	3/4"	1"
2	Domestic hot water outlet	3/4"	3/4"
3	Gas connection	1/2"	3/4"
4	Domestic cold water supply	3/4"	3/4"
5	Heating system return tapping	3/4"	1"
6	Combustion air connection	3"	3"
7	Flue outlet connection	3"	3"

Domestic Hot Water Flow Rate (Based on 70° temperature rise)

Model ¹	Gallons per minute
WMB-80C	2.0
WMB-120C	3.2
WMB-155C	4.0

Input MBH AHRI Certified Ratings

	Model ¹	Input MBH		AHRI Certified Ratings				Vent material	Boiler water content (Gallons)	Approx. shipping weight (Lbs.)
		Max.	Min.	DOE heating capacity MBH ²	Seasonal efficiency AFUE %	Net water rating MBH ³	Vent/air pipe size (Inches) ⁴			
HEAT ONLY	AB-80	80	8	75	95.0	65	2 or 3	PVC, CPVC, PP, SS	1.03	64
	AB-120	120	12	112	95.0	97	2 or 3	PVC, CPVC, PP, SS	1.23	67
	AB-155	155	15.5	144	95.0	125	2 or 3	PVC, CPVC, PP, SS	1.23	67
COMBI	AB-80C	80	8	75	95.0	65	2 or 3	PVC, CPVC, PP, SS	1.11	77
	AB-120C	120	12	112	95.0	97	2 or 3	PVC, CPVC, PP, SS	1.31	80
	AB-155C	155	15.5	144	95.0	125	2 or 3	PVC, CPVC, PP, SS	1.33	87

VENTING

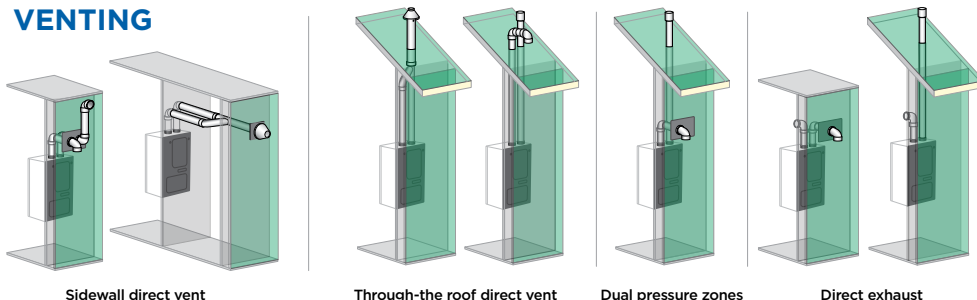

¹Natural gas field convertible to LP with optional kit.

²Based on standard test procedures prescribed by the United States Department of Energy. MBH refers to thousands of Btu per hour.

³Net AHRI ratings are based on net installed radiation of sufficient quantity for the requirement of the building and nothing needs to be added for normal piping and pick-up. Ratings are based on piping and pick-up allowance of 1.15. An additional allowance should be made for unusual piping and pick-up loads.

⁴Boilers must be vented directly to the outdoors. See boiler manuals for details.

In the interest of continual improvement in product and performance, Weil-McLain reserves the right to change specifications without notice.

Weil-McLain Customer Service: 800-654-2109

WM1908_FLY_069 AqB-s2



STANDARD EQUIPMENT:

BOILER

- Stainless Steel heat exchanger
- Mounting bracket and hardware
- Spark ignition
- Outdoor sensor
- Honeywell control
- T & P gauge
- 3-prong power cord
- Condensate drain
- Relief valve
- 3-in-1 Vent adapter
- Low NOx SCAQMD compliant

COMBI MODELS

- DHW flat plate heat exchanger
- 3-speed circulator

OPTIONAL EQUIPMENT

- Propane conversion kit
- Concentric vent kit
- Condensate neutralizer
- Water treatment inhibitor & test kit

WARRANTY

- 10 year limited warranty heat exchanger for residential use
- 5 year limited warranty heat exchanger for commercial use
- 2 year limited warranty all other parts